



# GLASS CABINET

ELEGANCE SISTEMA

elegance.tr





# GLASS CABINET

ELEGANCE SISTEMA

elegance.tr

## PROFILE SPECIFICATION

**CODE: 50.21.93**

MEASURE (mm) :3000x55x18



black



champain



## FITTIG COMPONENTS

### Kit Of The Profile Supports for the Glass

**CODE: 51.64.00**

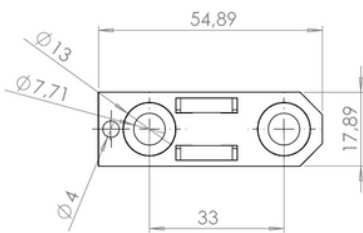

a

The kit consists of 4 profile fasteners (including Allen sets) and a glass gasket.

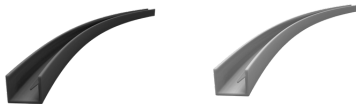

### 4/6mm Glass Gasket

**CODE: 51.18.00**

300 cm / Black Or White

### Kit Of The Profile Supports for The Wood

**CODE: 51.65.00**

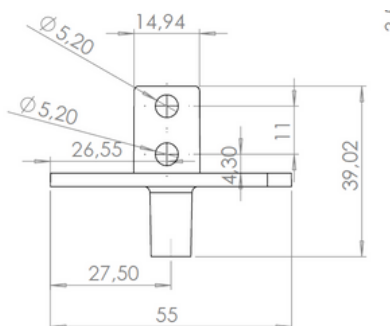

b

The kit consists of 4 fasteners including Allen set





## PROFILE ASSEMBLING

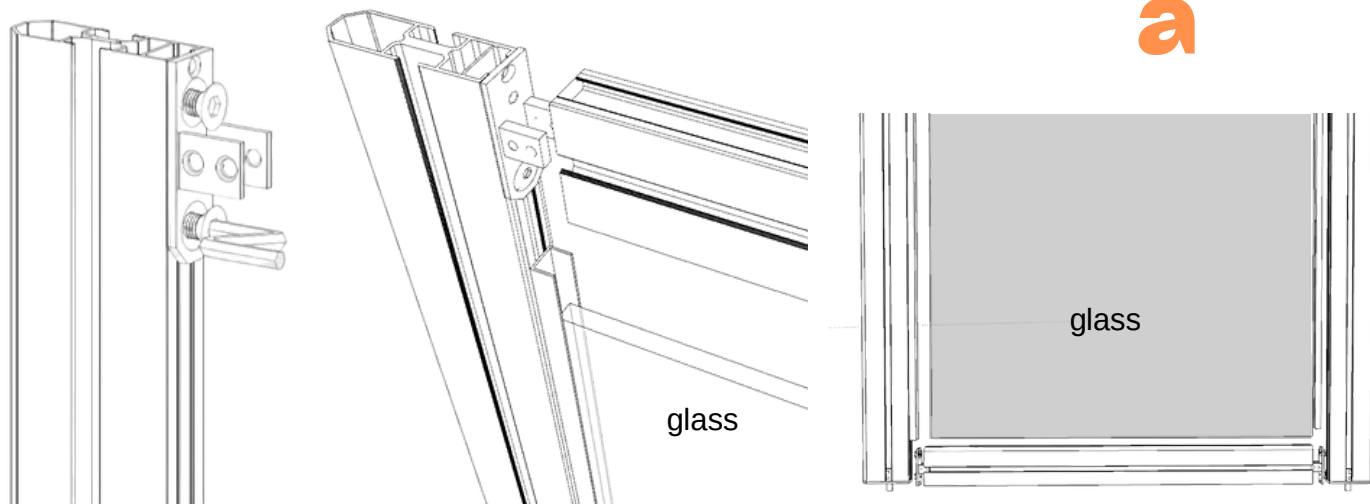

## WOODEN ASSEMBLING

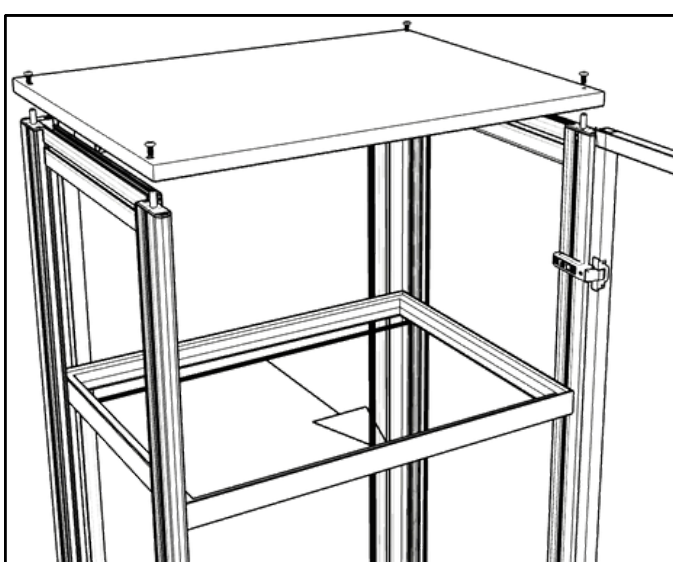
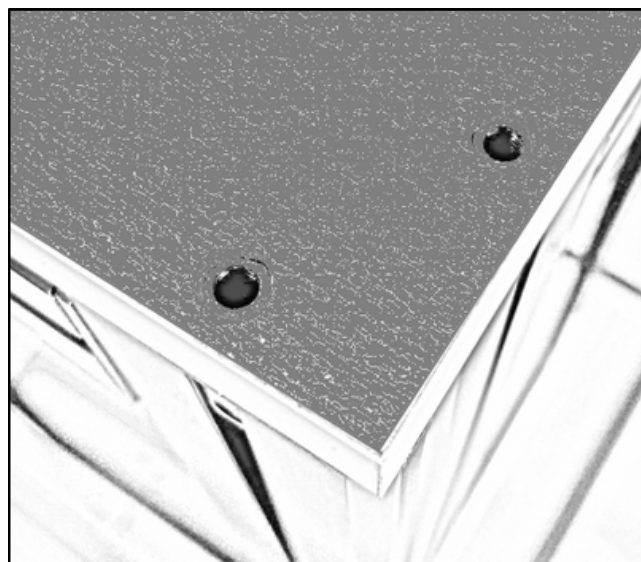
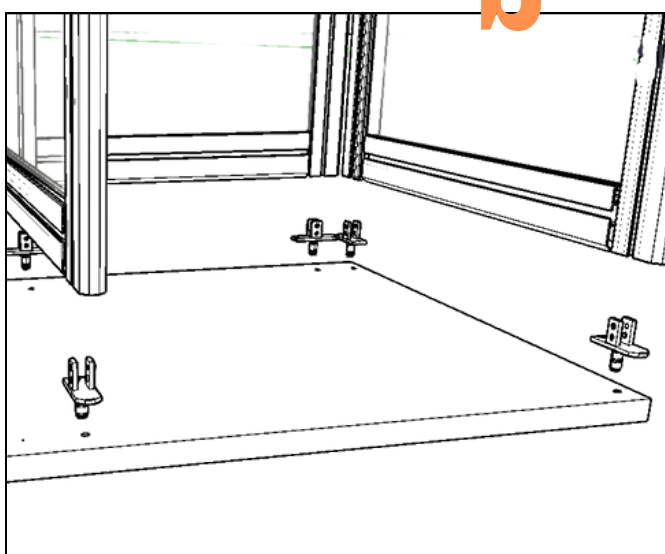
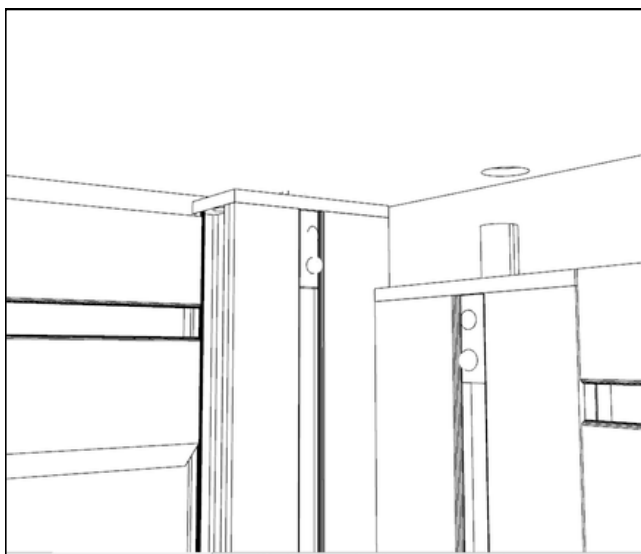



**Measurement Drilling 18MM TOP & BOTTOM  
WOODEN PANEL**

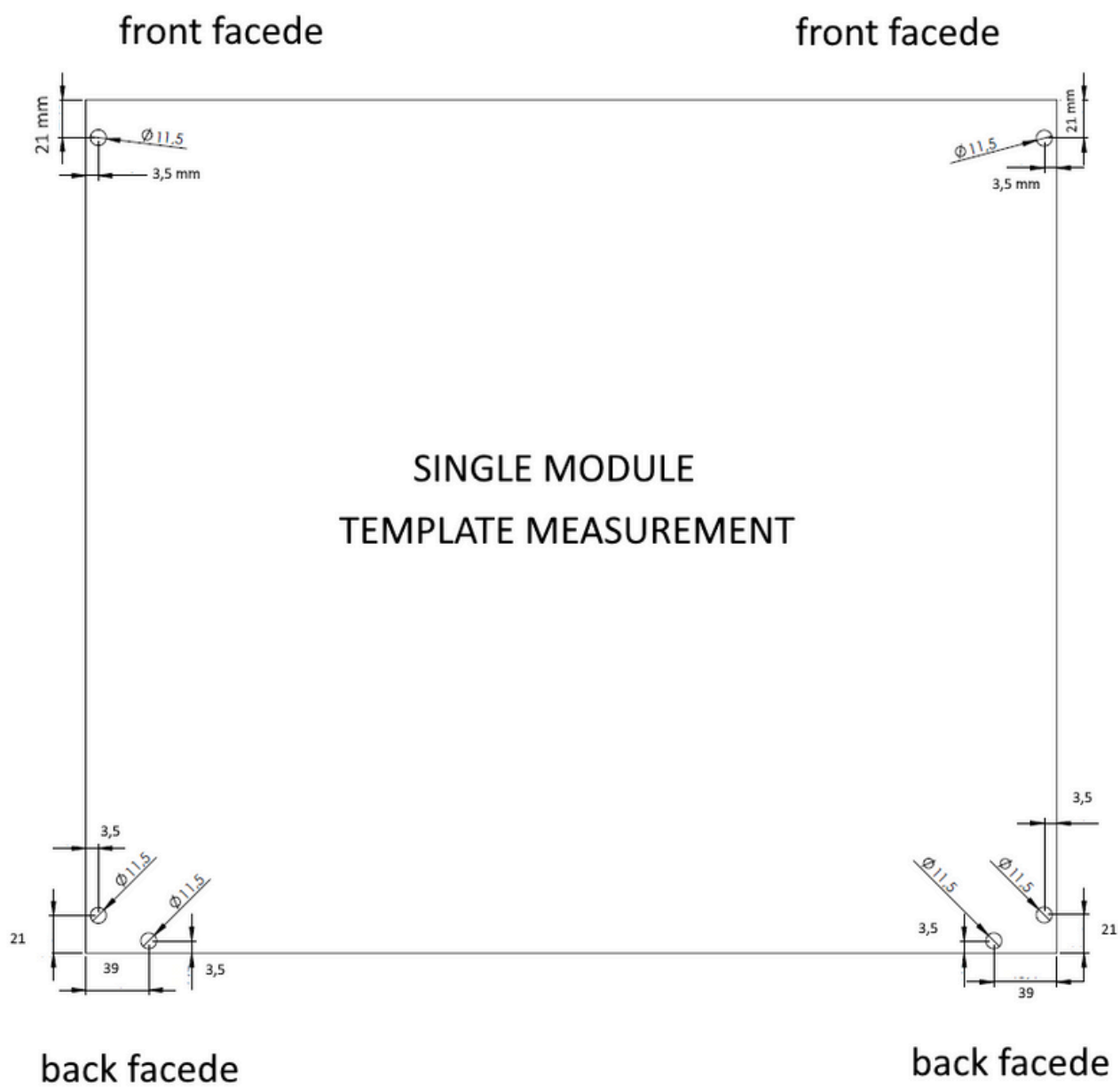



# GLASS CABINET

ELEGANCE SISTEMA

elegance.tr

## Glass for Aluminum Shelf By Ready To LED

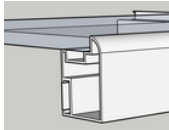
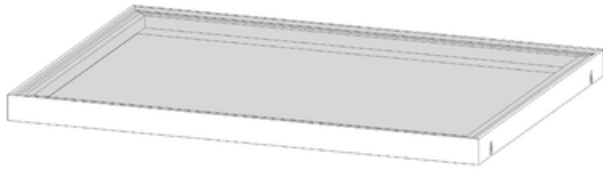

Glass Min 4 mm Max 6 mm

CODE :50.22.16

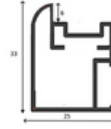

MEASURE (mm) :3000x33x25



black



champain

CODE :51.17.00



45 CONNECTION ITEM

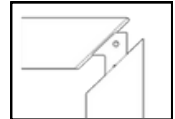

## Rectangle Aluminum Hanger Profile

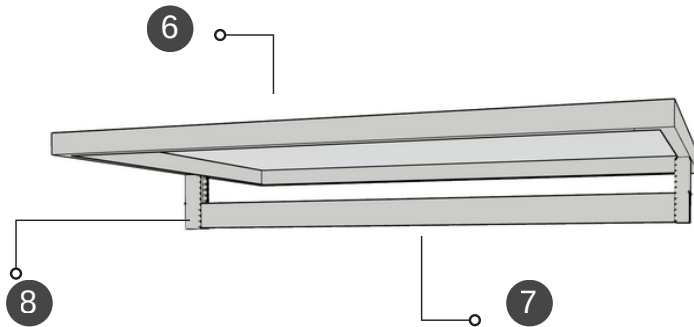

CODE :

50.21.99

50.29.38

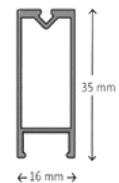
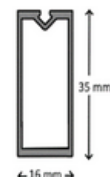

MEASURE (mm) :3000x35x16



black



champain

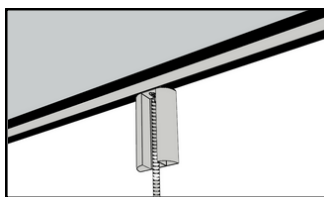

51.66.00

8



Glass Shelf  
Hanger Suppor  
9 Cm

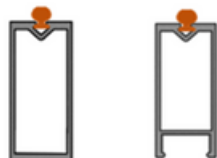

51.12.00

7

Anti-Slip Gasket

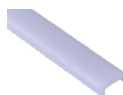

51.13.30

6

7

LED Cap Profile .  
Standard length  
is 300 cm